

Order no.: 115139

Folding scaffolding 0.75 x  
1.80 m with outrigger  
Platform height 4.04 m



### Accessories for the product family



Order no.: 027992  
Safety railing for mobile scaffolding



Order no.: 027971  
Folding frame unit, 0.75 m For scaffolding length: 1.8 m



Order no.: 027904  
Push-fit frame, 0.75 m. Height: 2.00 m



Order no.: 027955  
Railing lengthwise 1,800 mm

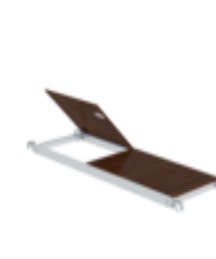

Order no.: 027931  
Platform with trapdoor For scaffolding length: 1.8 m



Order no.: 027913  
Toe board front side For scaffolding width: 0.75 m



Order no.: 027943  
Toe board long side For scaffolding length: 1.8 m



Order no.: 027937  
Diagonal brace 1.8 m



Order no.: 027935  
Horizontal strut For scaffolding length: 1.8 m



Order no.: 027926  
Triangular outrigger



Order no.: 027973

Swivel castor with spindle height adjustable Ø 125 mm



Order no.: 027940

Step-on bracket



Order no.: 027912

Ballast weight with hanging brackets RAL 1021

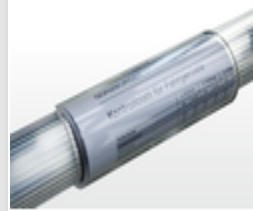

Order no.: 019081

Clip tray for tubes Ø 50 mm



Order no.: 027920

Wall spacer adjustable Adjustable up to 1.0 m



Order no.: 070506

Frame extension can be clamped on Adjustment range max. 400 mm



Order no.: 019274

Storage tray 500 x 220 mm Clamping range 38-51 mm



Order no.: 019276

Storage tray 800 x 300 mm Clamping range 38-51 mm



Order no.: 019175

Inspection sticker 40 x 40 mm



Order no.: 019176

Inventory sticker

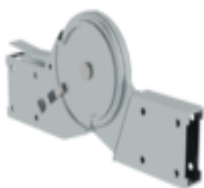

Order no.: 019477

Automatic steel hinge for scaffolding folding frame



Order no.: 070507

Safety door on front side Push-fit frame 0.75



Order no.: 019136

Spring clip for mobile scaffolding with short pin, closed



Order no.: 019137

Spring clip for mobile scaffolding with long pin, open



Order no.: 070524

Scaffolding strut telescopic 1,700-2,500 mm



Order no.: 027104

**Height-adjustable spindle**



Order no.: 027922

**Swivel castor with spindle, non-marking grey height adjustable Ø 200 mm**



Order no.: 027921

**Swivel castor with spindle, electrically conductive height adjustable Ø 200 mm**



Order no.: 027958

**Swivel castor Ø 200 mm With parking brake and pin**



Order no.: 027905

**Push-fit frame, 0.75 m. Height: 1.00 m**